

## ASSEMBLY INSTRUCTIONS

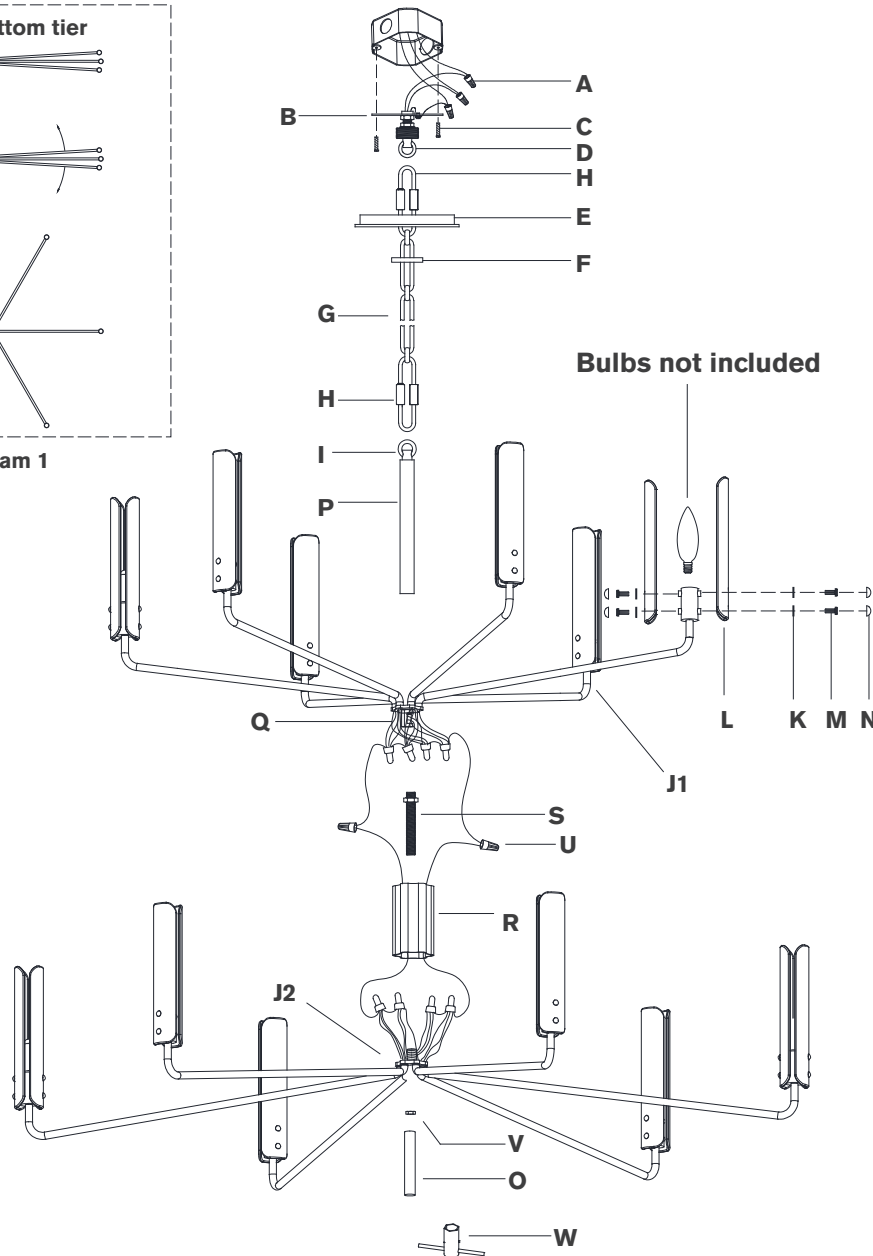
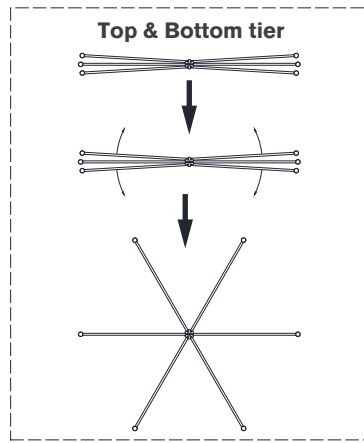

## Casoria Grande Two Tier Chandelier

Item # ARN 5486

### NOTICE:

This light fixture should be installed in accordance with all applicable, local installation codes, and by a person familiar with the construction and operation of it, as well as the hazards involved. Inspect item and contents carefully. If any damage or defect is found, do not install. Retain all packaging material until installation is complete and approved.

### TOOLS REQUIRED (NOT INCLUDED):

Phillips Screwdriver	Slotted Screwdriver	Chain Pliers
Slip Joint Pliers	Measuring Tape	Wire Cutters
Wire Strippers		

### PERSONS REQUIRED: Two

- Carefully remove all parts from the box. Place on a clean, soft surface.
- Rotate fixture arms into position as shown in diagram 1, spacing each arm evenly for top & bottom tiers.

**NOTE:** If needed, tighten hex nuts on arms using provided wrench (W).

- Remove collar loop (D) from chain (G) by unscrewing quick link (H).
- Install mounting plate (B) to junction box and secure with mounting screws (C).
- Secure collar loop (D) to mounting plate (B) using pliers to tighten locknut.
- Install canopy (E) to collar loop (D) by securing and secure with collar ring (F).
- Determine desired overall length, and amount of chain (G) needed. Shorten chain using chain pliers. (Keep extra chain)
- Feed fixture wire and ground wire through tube (P) and connect to top tier (J1).
- Attach chain (G) to collar loop (D) and to fixture loop (I) using quick links (H). Secure quick links (H).
- Install threaded tube (S) to hickey (Q) using pliers to tighten locknut.

**NOTE:** It is recommended to have a helper assist in supporting the fixture for steps 11-14.

VISUAL COMFORT





## ASSEMBLY INSTRUCTIONS

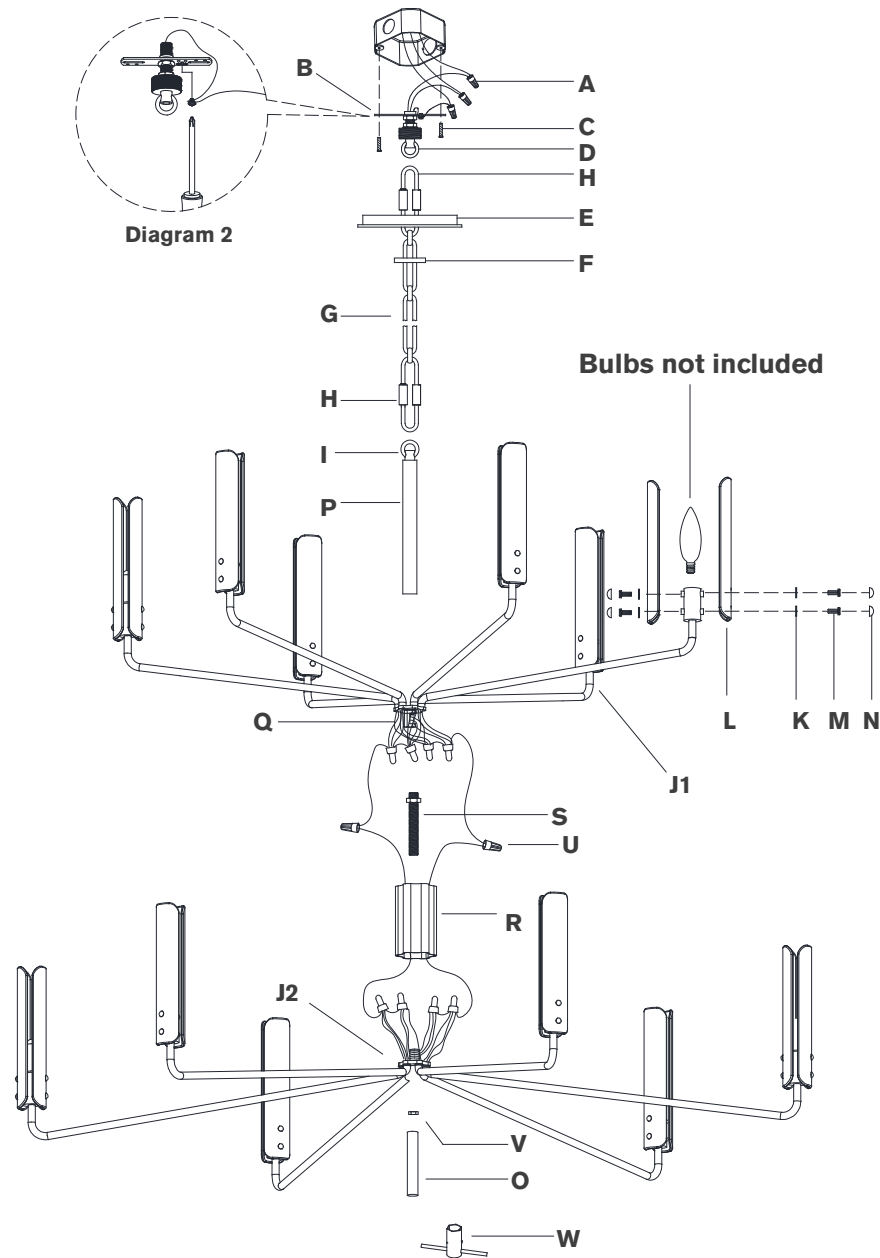

## Casoria Grande Two Tier Chandelier

Item # ARN 5486

### NOTICE:

This light fixture should be installed in accordance with all applicable, local installation codes, and by a person familiar with the construction and operation of it, as well as the hazards involved. Inspect item and contents carefully. If any damage or defect is found, do not install. Retain all packaging material until installation is complete and approved.

22. Connect fixture hot wire (smooth with markings) to the supply hot wire (usually black) using wire nut **(A)**.
- CAUTION:** Do not reverse the hot and neutral connections.
23. Make sure all wire connections are tight, then carefully tuck into the junction box.
24. Install canopy **(E)** to collar loop **(D)** and secure with collar ring **(F)**.
25. Install light bulbs into the sockets.
27. Attach glass panels **(L)** and rubber washers **(K)** to socket cup and secure with screws **(M)** and caps **(N)**.
- NOTE:** Do not overtighten otherwise glass could become damaged.

**Care Instructions:** Clean only with a soft dry cloth or feather duster. Do Not use abrasive or chemical agents.